

EXISTING LAYOUT PLAN OF  
NEW MORADABAD TOWNSHIP  
DELHI ROAD MORADABAD

NORTH



SCALE -1:1000

SECTOR-07

AREA CHART:-

- TOTAL AREA OF SCHEME = 106469.03
- AREA UNDER ROAD = 24667.60
- AREA UNDER PARK = 15920.19
- AREA UNDER NS/PS = 2939.61
- AREA UNDER LS = 3017.91
- AREA UNDER CONVSHOP = 1386.19
- AREA UNDER CF = 2187.99

PLOT DETAILS:-

12.0X24.0=288.00	
10.0X20.0=200.00	
9.0X21.0=189.00	
9.0X18.0=162.00	
9.0X14.0=126.00	
6.0X12.0=72.00	
4.50X9.0=40.50	

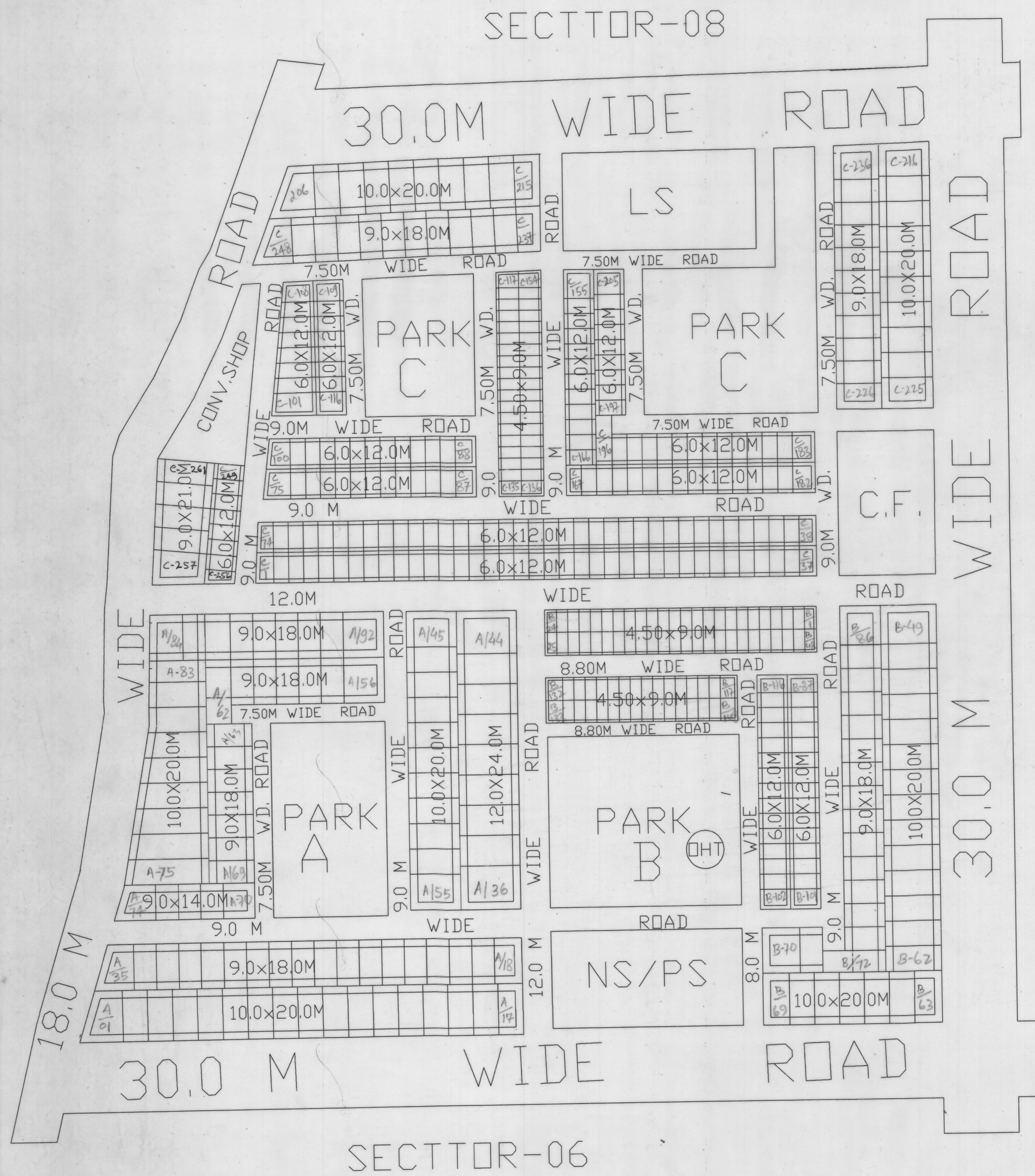

SECTOR-02

30.0 M WIDE ROAD

SECTOR-08

30.0M WIDE ROAD

30.0 M WIDE ROAD

SECTOR-06

*Ar*  
30/11/2007  
(VIJAY KUMAR SUBEY)  
SURVEYOR

*sd*  
14/11/2007  
TP/CTP

*sd*  
EE

*sd*  
10/11/2007  
SECT.

*sd*  
18/11/2007  
VC